

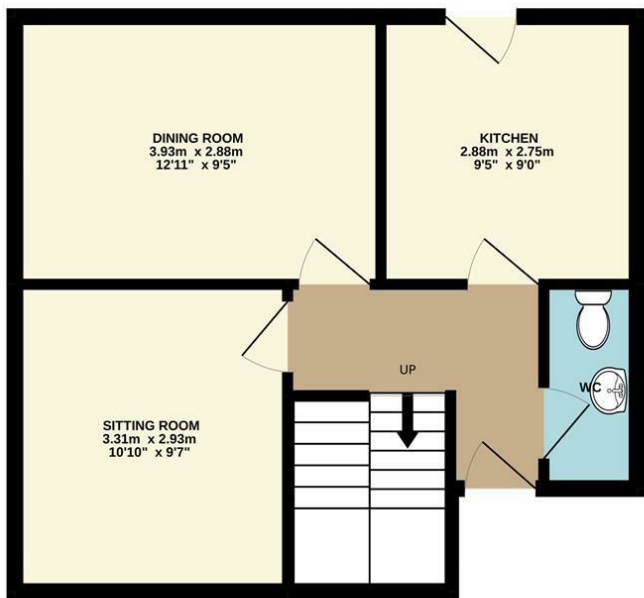

Munhaven Close | Norwich | NR11  
 Guide Price £180,000

abbotFox

GROUND FLOOR  
 39.1 sq.m. (421 sq.ft.) approx.



1ST FLOOR  
 41.3 sq.m. (445 sq.ft.) approx.

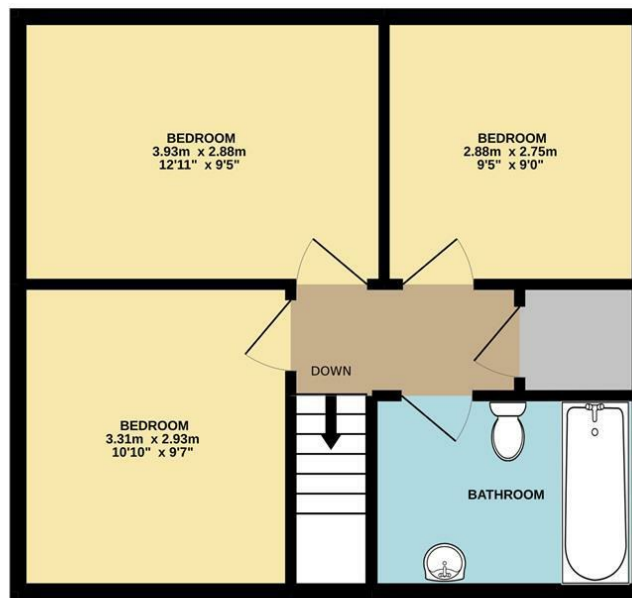

TOTAL FLOOR AREA : 80.4 sq.m. (866 sq.ft.) approx.

Whilst every attempt has been made to ensure the accuracy of the floorplan contained here, measurements of doors, windows, rooms and any other items are approximate and no responsibility is taken for any error, omission or mis-statement. This plan is for illustrative purposes only and should be used as such by any prospective purchaser. The services, systems and appliances shown have not been tested and no guarantee as to their operability or efficiency can be given.  
 Made with Metropix ©2022

Energy Efficiency Rating		Current	Potential
Very energy efficient - lower running costs			
(92 plus) A			88
(81-91) B			
(69-80) C			
(55-68) D		54	
(39-54) E			
(21-38) F			
(1-20) G			
Not energy efficient - higher running costs			
England & Wales		EU Directive 2002/91/EC	

Disclaimer – In accordance with the Property Misdescriptions Act, the company gives notice that all descriptions, references to condition, necessary permissions for use and other details are given in good faith and believed to be correct, but any intending lessees do not rely on them as statements of fact, but must satisfy themselves by inspection or other means, as to their accuracy.



abbotFox presents this three bedroom end-terrace house in the centre of the popular coastal village of Mundesley. The property is well situated within walking distance to the local shops, cafes, doctors surgery and the award winning sandy beach. Accommodation comprises of an entrance hall, sitting room, kitchen, dining room and a WC on the ground floor and three double bedrooms and a bathroom on the first floor. The property boasts a good sized rear garden and also benefits from a brick store shed. Requires modernisation throughout.

Guide Price - £180,000 - £190,000

